

Red Rock School is the Kremlin area one-room school for which we know the least, this in spite of the fact that our cousin Curtis Toews now owns the farm on which it was located, and it is the school for which the most remains are still visible.

Special thanks to our cousin Curtis Toews for covering the entire cost for the Red Rock School marker sign. Curtis spent his early childhood on the farm in the northwest quarter of the same section as the Red Rock school, with his parents, Pete and Thelma Toews, and he now owns the farm where the school was located as well. We also owe him our thanks for helping us with putting up the school marker signs, not only the Red Rock sign on his property but several of the others.

Special thanks to the following for their help with stories and photos:

Ellis, Dennis, and Janice Toews provided information about their mother having taught at Red Rock; they are our only source at this time; we very much hope for more!

1. Facts.

District number: 31½; we have no idea why, except that it is located between schools 31 and 32!

Location: SE corner of the SE quarter of Section 6-23-5 in Union Township; this is the only school from Union Township that fed into the Kremlin system for high school

Started: Presumably 1894, as for all of these schools

Last year of classes: No firm information available; still open Spring 1942

Fate of building: No information available

2. Location

A 1901 commercial plat map marking the location of School 31½ (Red Rock) is shown to the left below, and a 1906 government plat map is shown to the right below. The school location is highlighted, with no other useful landmarks. The 1901 plat map is important because it gives the school number,

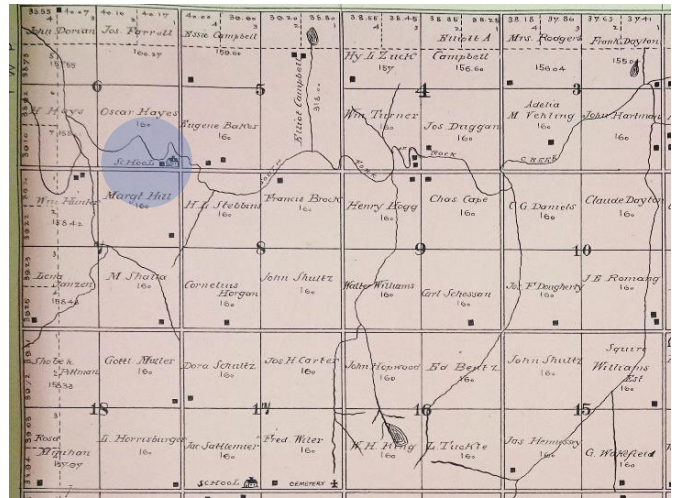
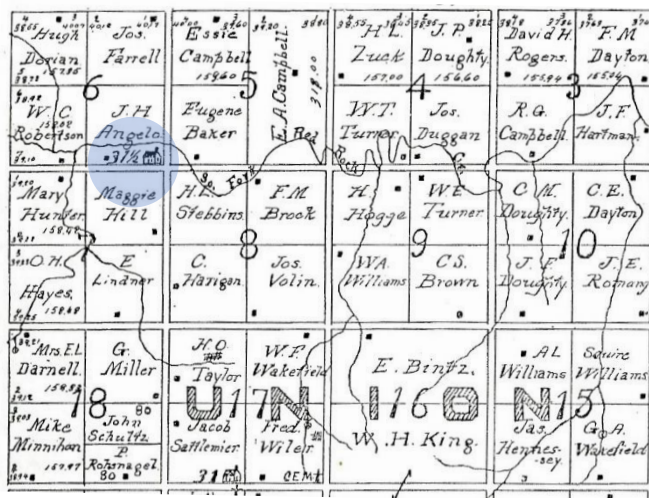

thus nailing down which school this was. School 31 is shown in these images also, 2 miles south and ½ mile east.



To the left above is an aerial photo of the school area from 1937, and to the right is the aerial photo from 1954; this area was not photographed in 1945 like several other areas, an image that might have been sharper and more informative. In the 1937 photo, the driveway appears to be toward the left of the circle, and there is still a gate and driveway at that location. Two structures are clearly visible just to the north of the road, and perhaps one to the east. Another building is visible toward the top of the circle. Which of these was the school building is not known. In the 1954 photo, one building is still clearly visible, but again, which of the school yard buildings this is/was is not known.

3. Known teachers.

Helena Janzen, later Mrs. Bill Toews, from her personal memories shared with us by her son Ellis Toews
Elnore Scott, from Enid, from the September 5, 1931, Enid Events newspaper listing; interestingly her husband John H. Scott, from the same source and with the same street address, is listed as the teacher at the Pleasant Valley school about 6 miles north

4. What (little) we know of the school.

In addition to the location maps, aerial photos, and the few teachers above, we know that Kremlin freshman students in the fall of 1942 included two who were listed in their senior Kremlin yearbook story as coming from Red Rock, Bud Hole and Helena Toews. Thus, the school must have still been in operation through the spring of 1942. We do not know about any later years. Bud Hole's family lived on the farm across the road south from the school. This Helena Toews was presumably the daughter of Henry A. Toews, who lived in the general area also.

In addition to the fact that his mother Helena Janzen Toews had taught at Red Rock early in her teaching career, Ellis also remembered his mother saying she had "lived in a farmhouse as a guest of a farm couple while she was teaching at Red Rock," and that "the house was very close to the school house." The plat maps above show a farm house/yard about ½ mile west from the school site, consistent with this memory. The cellar and other remains of that farm yard are still visible there.

Below are a few photos of the remains of the Red Rock School grounds. The upper left photo seems to have been the storm cellar; there is what appears to be a vent opening at both ends, and the former steps going down can just be seen, along with the cellar dugout being filled with scrap metal. This is near the southeast corner of the school grounds. The center photo is some remaining foundation from of the school buildings further to the west. The right photo is what we presume was the northwest corner post for a fence that likely surrounded the school grounds; not to fence students in, but to fence cattle out of the school yard! Again, we have no clear indication of exactly where the school itself stood.



Below are a few photos of the remains of the farmyard not quite a half mile west of the schools grounds, presumably where Helena Janzen stayed when she taught there. The left two photos show the storm cellar entrance and rounded cover; the right photo shows the concrete remains from the outhouse. These are easily visible from the road, and people should not trespass to view them.

